

MATCHLINE - SEE ABOVE

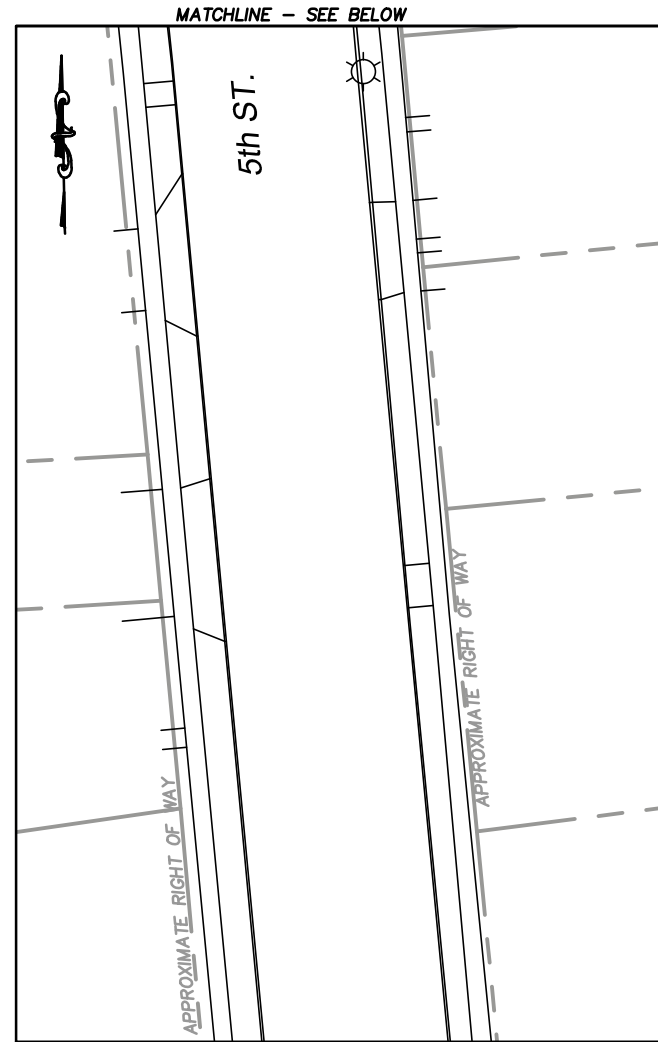

MATCHLINE - SHEET 2 OF 8



( IN FEET )  
1 inch = 40 ft.

**GENERAL NOTES:**

1. NORTH IS ORIENTED TO GRID NORTH FROM GPS OBSERVATION.
2. THE HORIZONTAL DATUM IS THE NORTH AMERICAN DATUM OF 1983 (NAD83/2011), NEW YORK STATE PLANE LONG ISLAND ZONE 3104.

**GENERAL NOTES:**

3. INFORMATION SHOWN HEREON IS FROM A FIELD SURVEY COMPLETED BY MJ ENGINEERING AND LAND SURVEYING, PC IN JANUARY 2017.
4. THE SHED AND PIER SHOWN ON SHEET 10 OF 10 ARE APPROXIMATE LOCATIONS AND WERE NOT SURVEYED.
5. UNAUTHORIZED ALTERATIONS OR ADDITION TO THIS SURVEY MAP IS A VIOLATION OF SECTION 7209 OF THE NEW YORK STATE EDUCATION LAW. COPIES OF THIS SURVEY MAP NOT BEARING THE LAND SURVEYORS SEAL AND SIGNED WITH RED INK SHALL NOT BE CONSIDERED TO BE VALID COPIES.

THE ALTERATION OF THIS MATERIAL IN ANY WAY, UNLESS DONE UNDER THE DIRECTION OF A COMPARABLE PROFESSIONAL, (I.E.) ARCHITECT FOR AN ARCHITECT, ENGINEER FOR AN ENGINEER OR LANDSCAPE ARCHITECT FOR A LANDSCAPE ARCHITECT, IS A VIOLATION OF THE NEW YORK STATE EDUCATION LAW AND/OR REGULATIONS AND IS A CLASS "A" MISDEMEANOR.

PROJ. MANAGER: JGM  
CHIEF DESIGNER:  
DESIGNED BY:  
DRAWN BY: JLC  
CHECKED BY: GMR

SEAL

**BL** ARCHITECTURE  
ENGINEERING  
ENVIRONMENTAL  
LAND SURVEYING  
274 Madison Ave, Suite 1401  
New York, NY 10016  
(212) 529-6543



Engineering and  
Land Surveying, P.C.

1533 Crescent Road - Clifton Park, NY 12065

BL COMPANIES  
EXHIBIT A  
THE VILLAGE OF GREENPORT

TOWN OF SOUTHOLD  
SUFFOLK COUNTY NEW YORK

SCALE: 1"= 40'  
CONTRACT No.:  
MJ PROJ. No.: 1226.05  
DATE: 03/21/2017

1 OF 8

MATCHLINE - SEE SHEET 1 OF 8

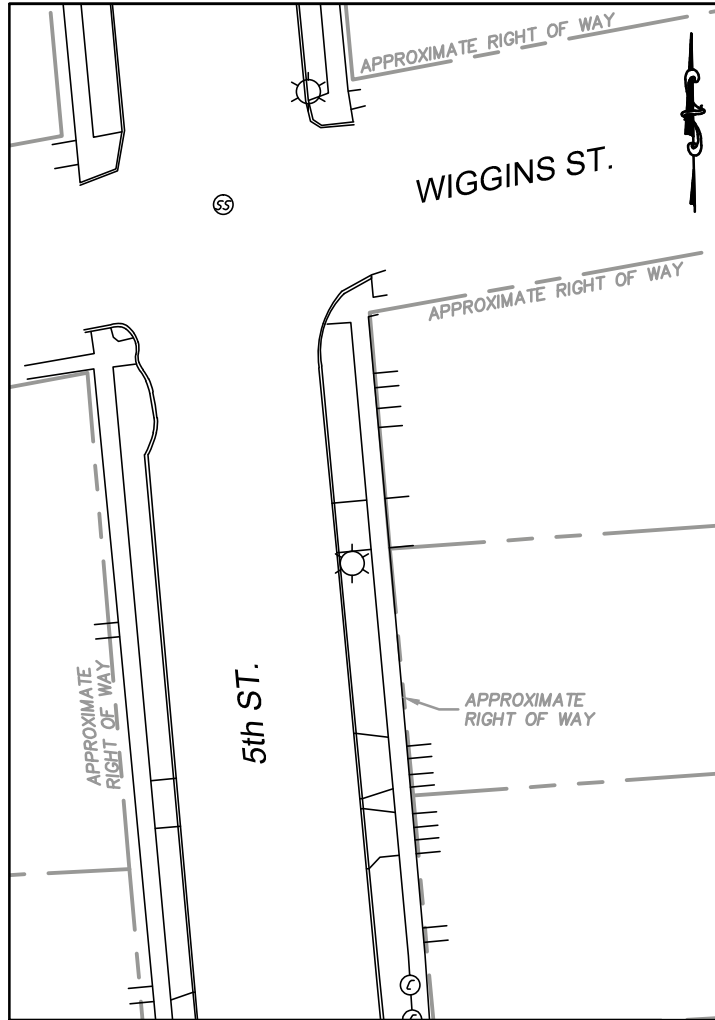

MATCHLINE - SEE ABOVE



( IN FEET )

1 inch = 40 ft.

THE ALTERATION OF THIS MATERIAL IN ANY WAY, UNLESS DONE UNDER THE DIRECTION OF A COMPARABLE PROFESSIONAL, (I.E.) ARCHITECT FOR AN ARCHITECT, ENGINEER FOR AN ENGINEER OR LANDSCAPE ARCHITECT FOR A LANDSCAPE ARCHITECT, IS A VIOLATION OF THE NEW YORK STATE EDUCATION LAW AND/OR REGULATIONS AND IS A CLASS "A" MISDEMEANOR.

MATCHLINE - SEE BELOW

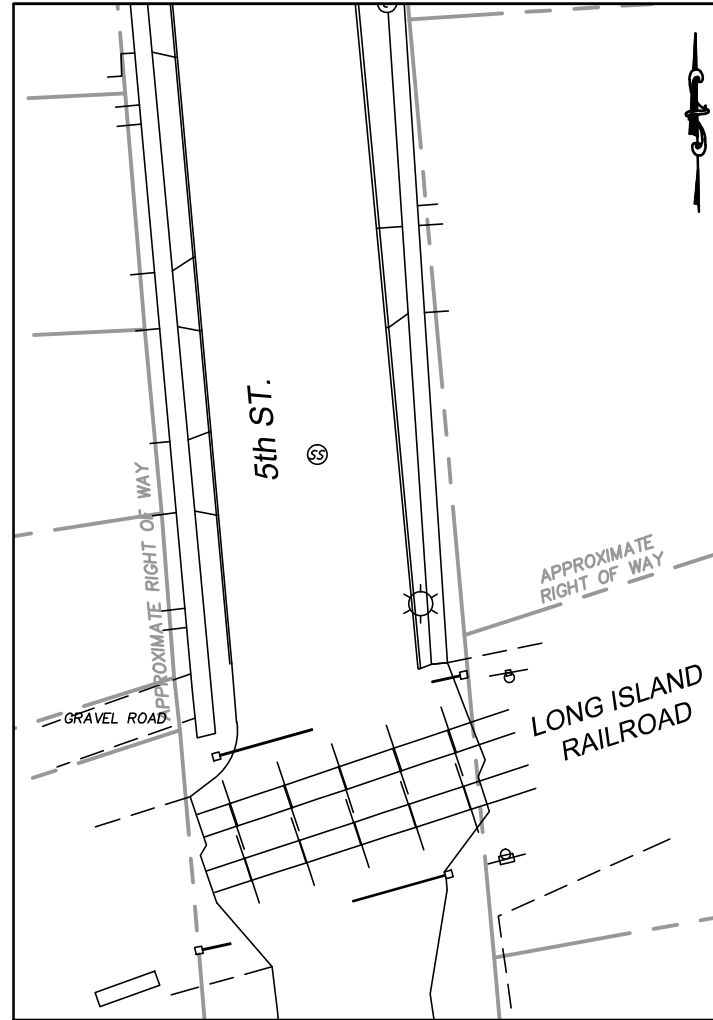

MATCHLINE - SEE SHEET 3 OF 8

PROJ. MANAGER:	JGM
CHIEF DESIGNER:	
DESIGNED BY:	
DRAWN BY:	JLC
CHECKED BY:	GMR

SEAL



ARCHITECTURE  
ENGINEERING  
ENVIRONMENTAL  
LAND SURVEYING  
274 Madison Ave, Suite 1401  
New York, NY 10016  
(212) 529-6543



Engineering and  
Land Surveying, P.C.

1533 Crescent Road - Clifton Park, NY 12065

BL COMPANIES

EXHIBIT A  
THE VILLAGE OF GREENPORT

TOWN OF SOUTHOLD  
SUFFOLK COUNTY NEW YORK

SCALE: 1"= 40'  
CONTRACT No.:  
MJ PROJ. No.: 1226.05  
DATE: 03/21/2017

2 OF 8

MATCHLINE - SEE SHEET 2 OF 8

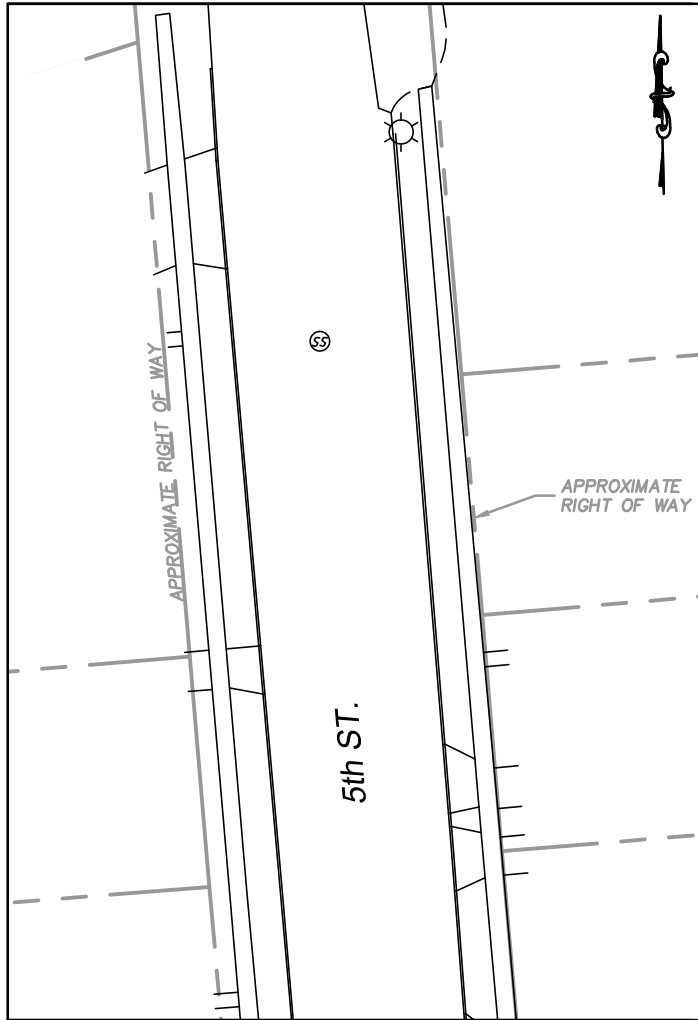

MATCHLINE - SEE BELOW

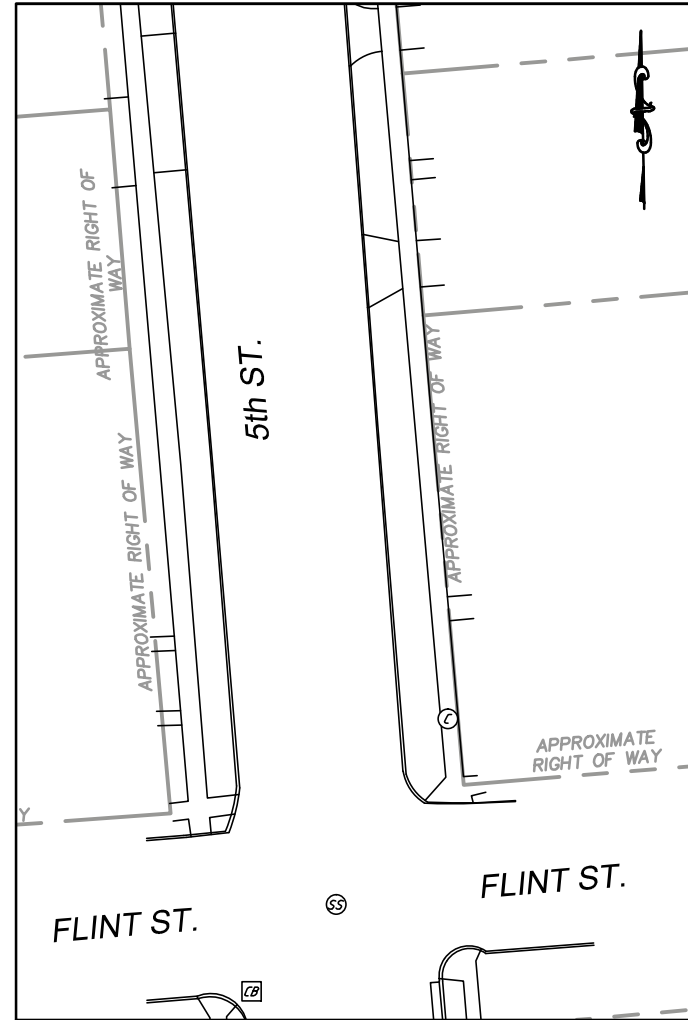

MATCHLINE - SEE ABOVE



( IN FEET )

1 inch = 40 ft.

THE ALTERATION OF THIS MATERIAL IN ANY WAY, UNLESS DONE UNDER THE DIRECTION OF A COMPARABLE PROFESSIONAL, (I.E.) ARCHITECT FOR AN ARCHITECT, ENGINEER FOR AN ENGINEER OR LANDSCAPE ARCHITECT FOR A LANDSCAPE ARCHITECT, IS A VIOLATION OF THE NEW YORK STATE EDUCATION LAW AND/OR REGULATIONS AND IS A CLASS "A" MISDEMEANOR.

PROJ. MANAGER: JGM  
 CHIEF DESIGNER:  
 DESIGNED BY:  
 DRAWN BY: JLC  
 CHECKED BY: GMR

SEAL



ARCHITECTURE  
 ENGINEERING  
 ENVIRONMENTAL  
 LAND SURVEYING  
 274 Madison Ave, Suite 1401  
 New York, NY 10016  
 (212) 529-6543



Engineering and  
 Land Surveying, P.C.

1533 Crescent Road - Clifton Park, NY 12065

BL COMPANIES

EXHIBIT A  
 THE VILLAGE OF GREENPORT

TOWN OF SOUTHOLD

SUFFOLK COUNTY

NEW YORK

SCALE: 1" = 40'  
 CONTRACT No.:  
 MJ PROJ. No.: 1226.05  
 DATE: 03/21/2017

3 OF 8

MATCHLINE - SEE SHEET 3 OF 8

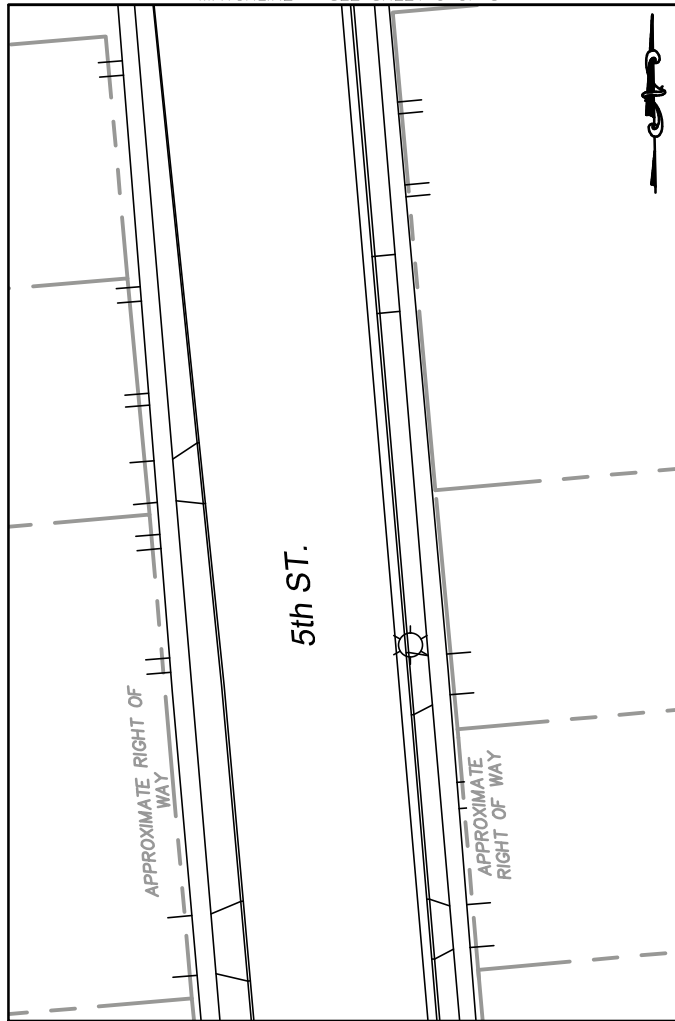

MATCHLINE - SEE BELOW

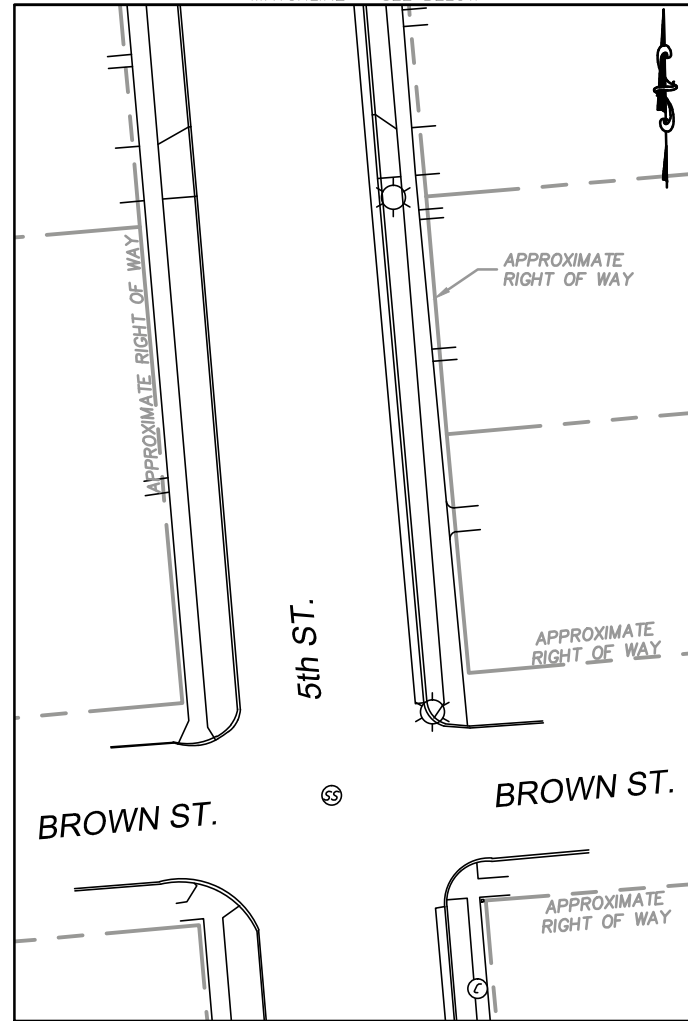

MATCHLINE - SEE ABOVE



( IN FEET )  
1 inch = 40 ft.

MATCHLINE - SEE SHEET 5 OF 8

THE ALTERATION OF THIS MATERIAL IN ANY WAY, UNLESS DONE UNDER THE DIRECTION OF A COMPARABLE PROFESSIONAL, (I.E.) ARCHITECT FOR AN ARCHITECT, ENGINEER FOR AN ENGINEER OR LANDSCAPE ARCHITECT FOR A LANDSCAPE ARCHITECT, IS A VIOLATION OF THE NEW YORK STATE EDUCATION LAW AND/OR REGULATIONS AND IS A CLASS "A" MISDEMEANOR.

PROJ. MANAGER: JGM  
 CHIEF DESIGNER:  
 DESIGNED BY:  
 DRAWN BY: JLC  
 CHECKED BY: GMR

SEAL



ARCHITECTURE  
 ENGINEERING  
 ENVIRONMENTAL  
 LAND SURVEYING  
 274 Madison Ave, Suite 1401  
 New York, NY 10016  
 (212) 529-6543



Engineering and  
 Land Surveying, P.C.  
 1533 Crescent Road - Clifton Park, NY 12065

BL COMPANIES  
 EXHIBIT A  
 THE VILLAGE OF GREENPORT  
 TOWN OF SOUTHOLD  
 SUFFOLK COUNTY NEW YORK

SCALE: 1"= 40'  
 CONTRACT No.:  
 MJ PROJ. No.: 1226.05  
 DATE: 03/21/2017

4 OF 8

MATCHLINE - SEE SHEET 4 OF 8

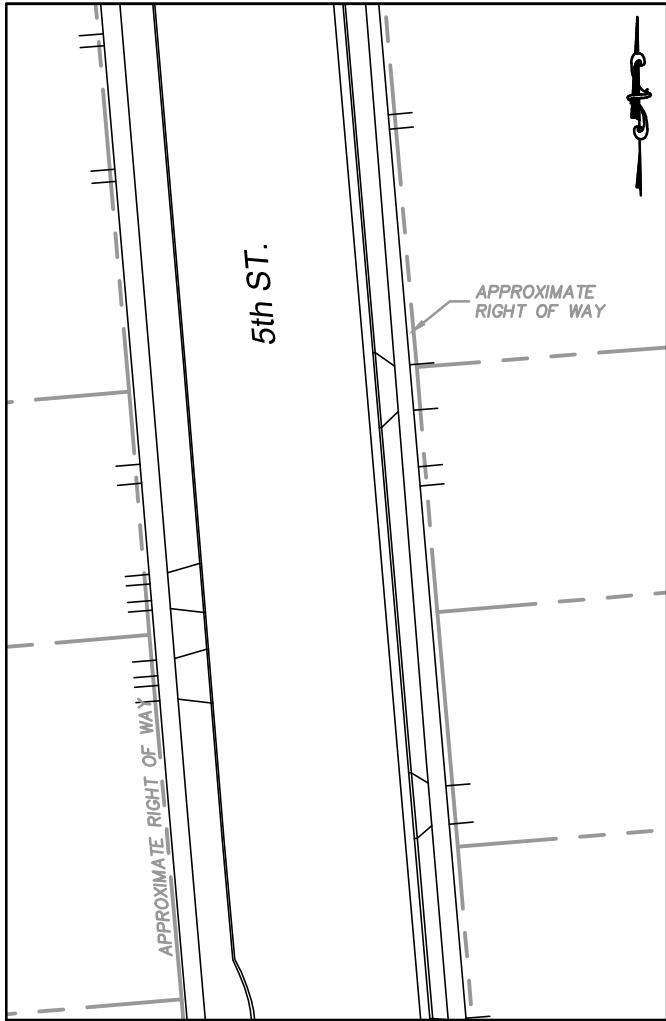

MATCHLINE - SEE BELOW

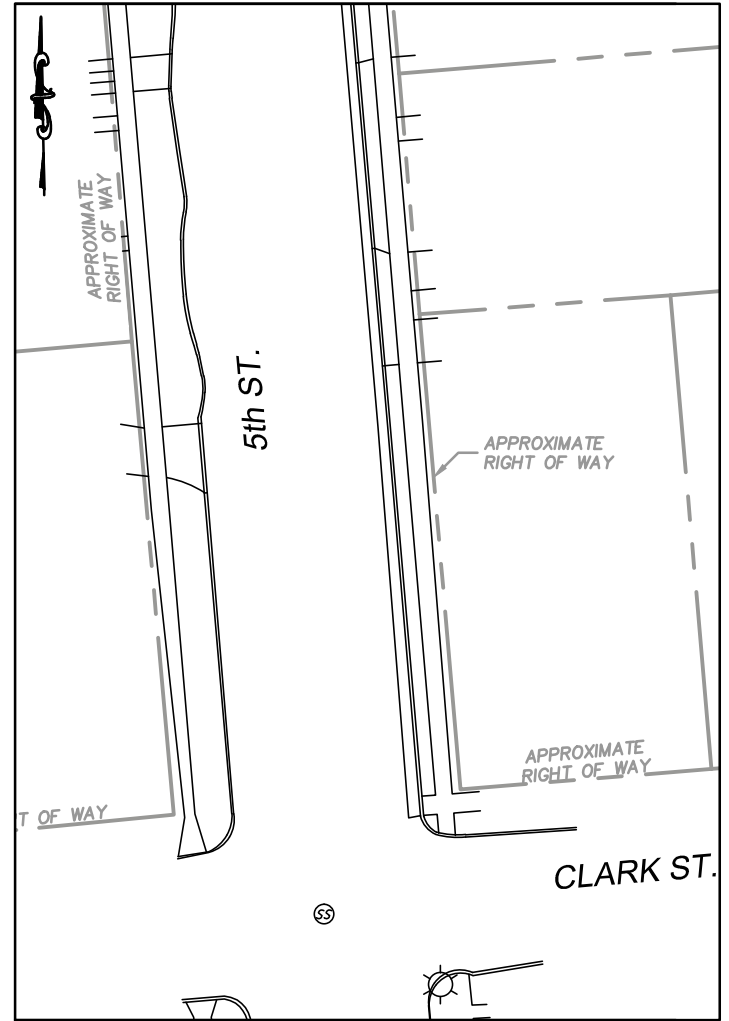

MATCHLINE - SEE ABOVE

MATCHLINE - SEE SHEET 6 OF 8

THE ALTERATION OF THIS MATERIAL IN ANY WAY, UNLESS DONE UNDER THE DIRECTION OF A COMPARABLE PROFESSIONAL, (I.E.) ARCHITECT FOR AN ARCHITECT, ENGINEER FOR AN ENGINEER OR LANDSCAPE ARCHITECT FOR A LANDSCAPE ARCHITECT, IS A VIOLATION OF THE NEW YORK STATE EDUCATION LAW AND/OR REGULATIONS AND IS A CLASS "A" MISDEMEANOR.

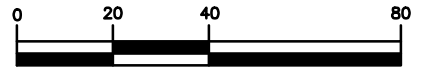

( IN FEET )  
1 inch = 40 ft.

PROJ. MANAGER:	JGM
CHIEF DESIGNER:	
DESIGNED BY:	
DRAWN BY:	JLC
CHECKED BY:	GMR

SEAL

**BL** ARCHITECTURE  
ENGINEERING  
ENVIRONMENTAL  
LAND SURVEYING  
274 Madison Ave, Suite 1401  
New York, NY 10016  
(212) 529-6543

**Engineering and  
Land Surveying, P.C.**  
1533 Crescent Road - Clifton Park, NY 12065

BL COMPANIES  
EXHIBIT A  
THE VILLAGE OF GREENPORT  
TOWN OF SOUTHOLD  
SUFFOLK COUNTY NEW YORK

SCALE: 1"= 40'  
CONTRACT No.:  
MJ PROJ. No.: 1226.05  
DATE: 03/21/2017  
**5 OF 8**

MATCHLINE - SEE SHEET 5 OF 8

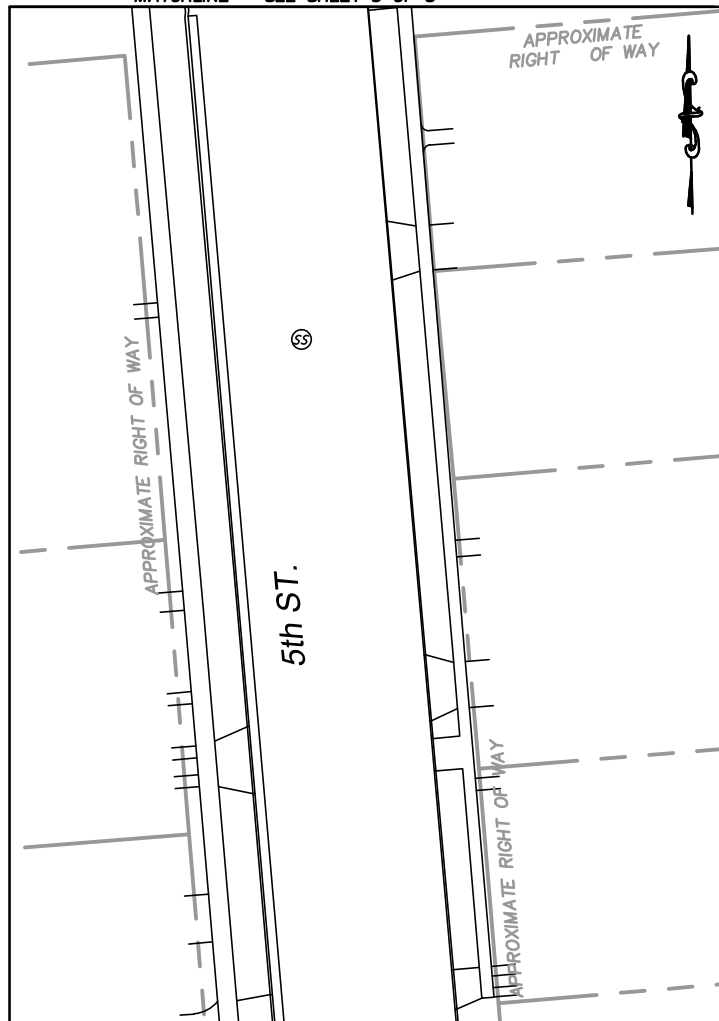

MATCHLINE - SEE BELOW

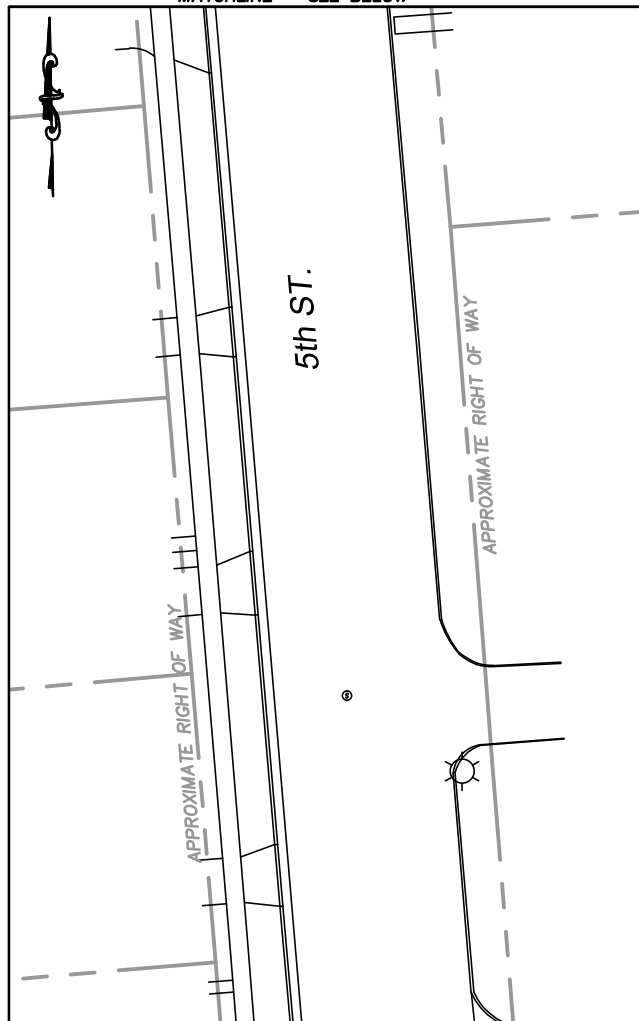

MATCHLINE - SEE ABOVE

MATCHLINE - SEE SHEET 7 OF 8

THE ALTERATION OF THIS MATERIAL IN ANY WAY, UNLESS DONE UNDER THE DIRECTION OF A COMPARABLE PROFESSIONAL, (I.E.) ARCHITECT FOR AN ARCHITECT, ENGINEER FOR AN ENGINEER OR LANDSCAPE ARCHITECT FOR A LANDSCAPE ARCHITECT, IS A VIOLATION OF THE NEW YORK STATE EDUCATION LAW AND/OR REGULATIONS AND IS A CLASS "A" MISDEMEANOR.

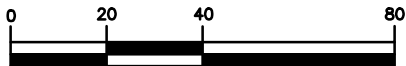

( IN FEET )

1 inch = 40 ft.

PROJ. MANAGER: JGM  
 CHIEF DESIGNER:  
 DESIGNED BY:  
 DRAWN BY: JLC  
 CHECKED BY: GMR

SEAL



ARCHITECTURE  
 ENGINEERING  
 ENVIRONMENTAL  
 LAND SURVEYING  
 274 Madison Ave, Suite 1401  
 New York, NY 10016  
 (212) 529-6543



Engineering and  
 Land Surveying, P.C.

1533 Crescent Road - Clifton Park, NY 12065

BL COMPANIES  
 EXHIBIT A  
 THE VILLAGE OF GREENPORT

TOWN OF SOUTHDOLD  
 SUFFOLK COUNTY NEW YORK

SCALE: 1"= 40'  
 CONTRACT No.:  
 MJ PROJ. No.: 1226.05  
 DATE: 03/21/2017

6 OF 8

MATCHLINE - SEE SHEET 6 OF 8

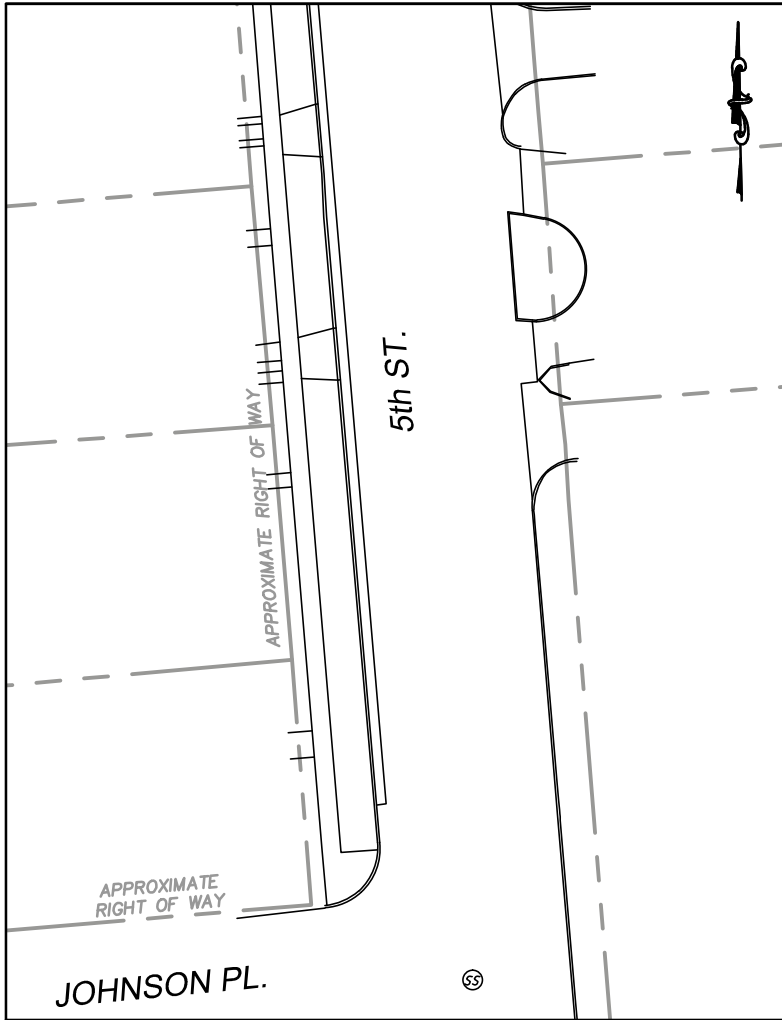

MATCHLINE - SEE ABOVE

MATCHLINE - SEE BELOW

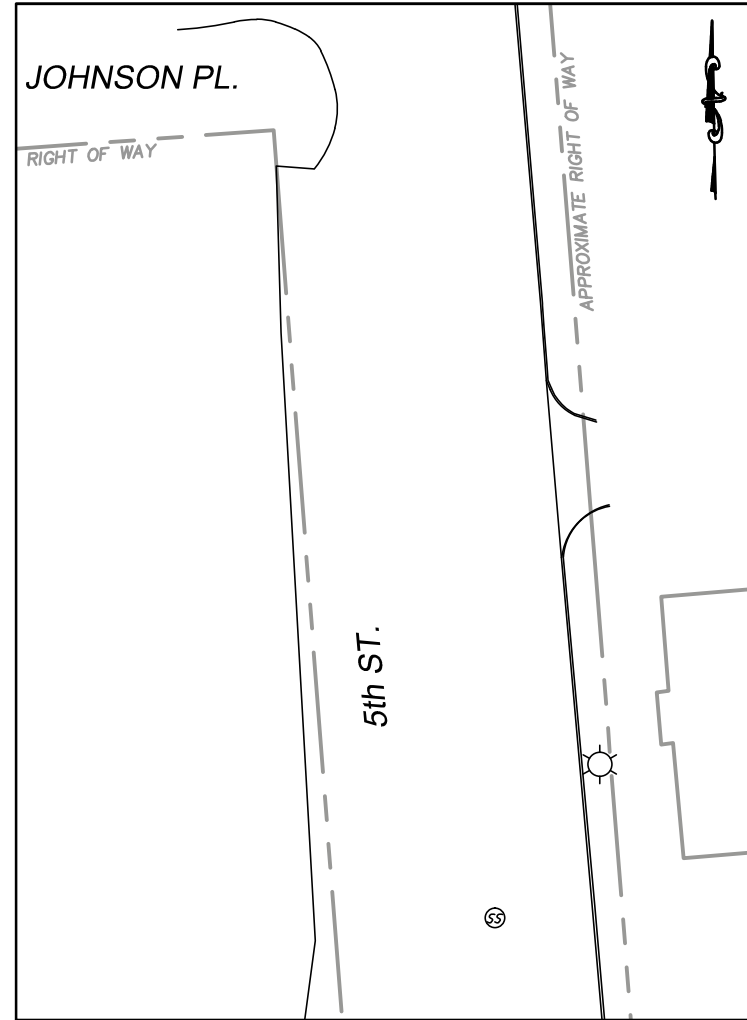

MATCHLINE - SEE SHEET 8 OF 8

THE ALTERATION OF THIS MATERIAL IN ANY WAY, UNLESS DONE UNDER THE DIRECTION OF A COMPARABLE PROFESSIONAL, (I.E.) ARCHITECT FOR AN ARCHITECT, ENGINEER FOR AN ENGINEER OR LANDSCAPE ARCHITECT FOR A LANDSCAPE ARCHITECT, IS A VIOLATION OF THE NEW YORK STATE EDUCATION LAW AND/OR REGULATIONS AND IS A CLASS "A" MISDEMEANOR.

PROJ. MANAGER: JGM  
 CHIEF DESIGNER:  
 DESIGNED BY:  
 DRAWN BY: JLC  
 CHECKED BY: GMR

SEAL



ARCHITECTURE  
 ENGINEERING  
 ENVIRONMENTAL  
 LAND SURVEYING  
 274 Madison Ave, Suite 1401  
 New York, NY 10016  
 (212) 529-6543



Engineering and  
 Land Surveying, P.C.

1533 Crescent Road - Clifton Park, NY 12065

BL COMPANIES

EXHIBIT A  
 THE VILLAGE OF GREENPORT

TOWN OF SOUTHOLD

SUFFOLK COUNTY

NEW YORK

SCALE: 1"= 40'  
 CONTRACT No.:  
 MJ PROJ. No.: 1226.05  
 DATE: 03/21/2017

7 OF 8

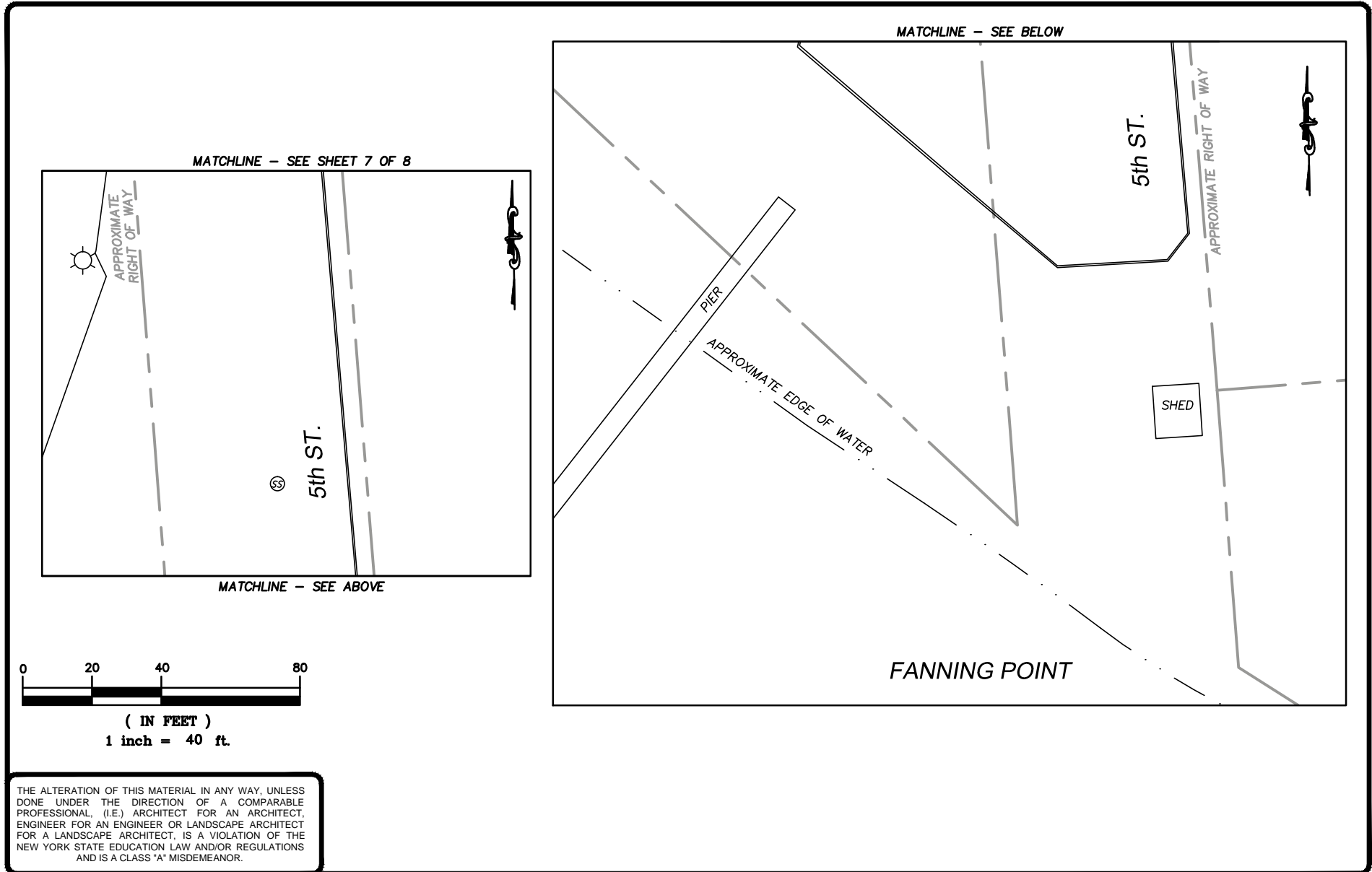

PROJ. MANAGER:	JGM
CHIEF DESIGNER:	
DESIGNED BY:	
DRAWN BY:	JLC
CHECKED BY:	GMR

SEAL

**BL** ARCHITECTURE  
ENGINEERING  
ENVIRONMENTAL  
LAND SURVEYING  
Companies  
274 Madison Ave, Suite 1401  
New York, NY 10016  
(212) 529-6543

**M** Engineering and  
Land Surveying, P.C.  
1533 Crescent Road - Clifton Park, NY 12065

BL COMPANIES  
EXHIBIT A  
THE VILLAGE OF GREENPORT  
TOWN OF SOUTHOLD  
SUFFOLK COUNTY NEW YORK

SCALE: 1" = 40'  
CONTRACT No.:  
MJ PROJ. No.: 1226.05  
DATE: 03/21/2017  
**8 OF 8**